

INDUSTRIAL BLANKET



It is a stone wool blanket that is used for thermal insulation and fire safety of industrial plants, process equipments, large diameter pipes.

Application

Noncombustibility of Stone Wool Industrial Blankets enables them to be used for thermal, sound and fire insulation of very high temperatures. The blankets are cut to size and wrapped around the surface to be insulated. The joints are laced with galvanized wire by passing it through the eyes of the wiremesh. Care should be taken to ensure that the joints fit properly and no gap is left at the joints. During the application on large surfaces, the blankets should be impaled over welded pins of 5-6 in number per square meter. The blankets are held in position by placing retaining washers over the pins. These pins also work as spacers for the insulation between the sheet metal cover and the insulated surface.

There are three different types of industrial blankets available as 650, 700 and 750 with different technical properties.

650 - 700	Thickness (cm)	Width x Length (cm)	Package (m ²)
	3	100 x 800	8
	4	100 x 800	8
	5	100 x 500	5
	6	100 x 500	5
	8	100 x 300	3
	10	100 x 300	3
	12	100 x 300	3

750	Thickness (cm)	Width x Length (cm)	Package (m ²)
	3	100 x 800	8
	4	100 x 600	6
	5	100 x 500	5
	6	100 x 400	4
	8	100 x 300	3
	10	100 x 300	3

Type		650	700	750
Density (kg/m ³)		80	90	125
Declared Thermal Conductivity (W/mk)	Average Temperature (°C)			
	50	0,038	0,038	0,037
	100	0,047	0,046	0,044
	150	0,058	0,057	0,052
	200	0,069	0,066	0,061
	250	0,083	0,079	0,071
	300	0,098	0,093	0,082
350	0,115	0,108	0,094	



- High thermal insulation
- Fire safety
- Sound insulation
- Easy to apply



TECHNICAL DATA SHEET

izocam Industrial Blanket

Properties	Symbol	Unit	Description							Tolerance	Standard	
Material Type			650	700	750					-	-	
Material	-	-	Stone Wool							-	TS EN 14303	
Density	ρ	kg/m ³	80	90	125					+/-10%	-	
Width	b	mm	1000							+/-10	TS EN 822	
Length	l	mm	8000	5000	3000					-0, + ∞	TS EN 822	
Thickness	d	mm	30	40	50	60	80	100	120 *	T2 **	TS EN 823	
Facing	-	-	Stitched with Galvanized Wire							-	-	
Reaction to fire	-	-	A1							-	TS EN 13501-1	
Declared Thermal Conductivity	T	°C	50	100	150	200	250	300	350	-	TS EN 12667/12939 13787	
	Type 650	λ_D	W/m.K	0,038	0,047	0,058	0,069	0,083	0,098			0,115
	Type 700			0,038	0,046	0,057	0,066	0,079	0,093			0,108
	Type 750			0,037	0,044	0,052	0,061	0,071	0,082			0,094
Max. Service Temperature	-	°C	650							-	TS EN 14706	
Water Vapor Diffusion Resistance Coefficient ***	μ	-	1							-	TS EN 12086	
Packaging Material	-	-	PE Film							-	-	

• Type 750 blankets can be manufactured up to 10 cm thickness.

** T2: -5% or +5 mm; +15% or +15 mm. The biggest value is chosen at minus tolerance, the smallest value is chosen at plus tolerance.

*** Literature value.

Safety Reminders for Loading, Unloading, Shipping and Storing

- These operations should be done indoors in case of rainy weather conditions.
- Loading and unloading should be done by (at least) two people.
- Products should be put on top of each other with extra care.
- Only backshutter of the truck body should be opened during unloading.
- Unloading should be carried out from backside to the front.
- Products should be wrapped by a waterproof cover even if the shipping distance is short.
- Products should be in packages (10 each) and maximum 6 packages can be superposed.
- Products should not be put into upright position during shipping and storing.
- Storing should be carried out by using pallets. But they should not superposed with pallets.
- Products should not be pulled by their package.
- Products should not be stepped on and should not be used as steps.
- The packages should be put on the floor with extra care so the corners of the product especially is not damaged by a hit.

Izocam is not responsible for any problem because of misprinting. Izocam, the manufacturer, reserves the right to alter product specifications without prior notice. Izocam also manufactures special products upon request. For your requirements, you are requested to contact our Export Department.

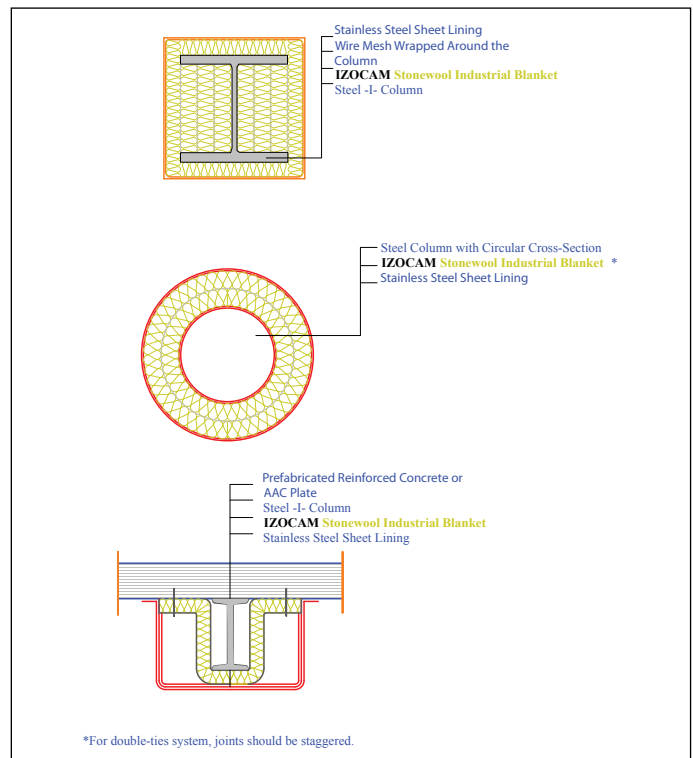

ENTYSS2015/06